

# Assembly instructions

Congratulations on the purchase of your performance line MIP captain panel kit.  
We advice you to carefully check the contents and read these instructions prior to starting the assembly.

## CONTENTS

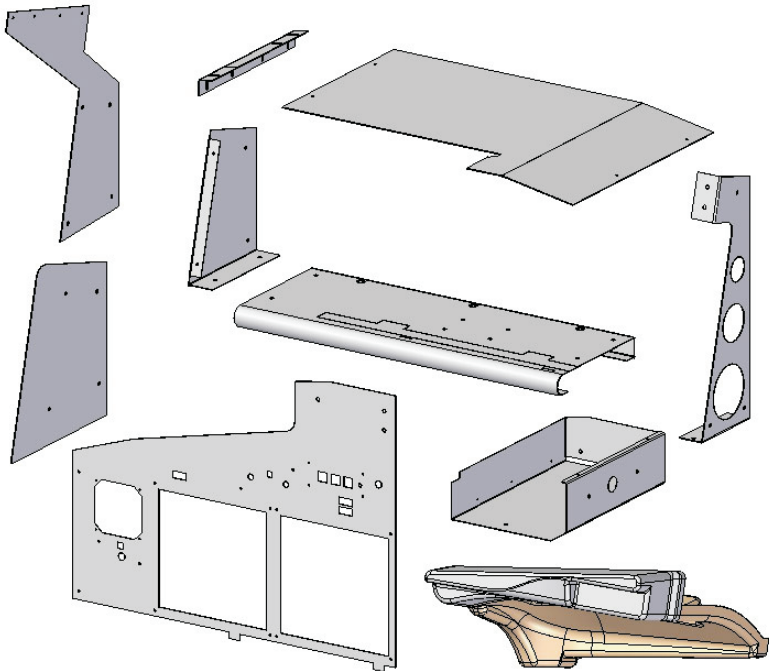

Aluminium parts & Glare wing

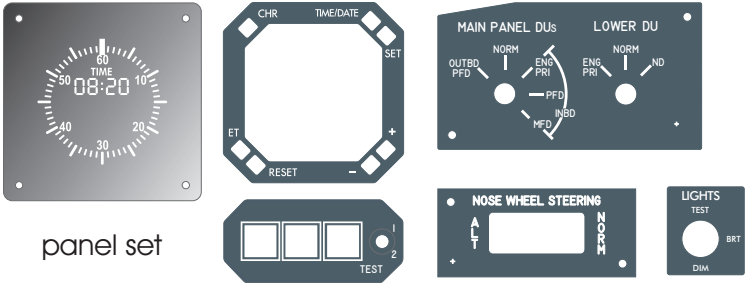

panel set

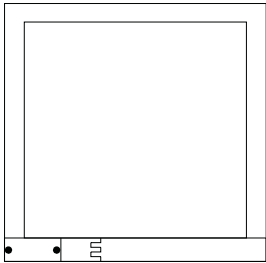

window frame  
2x



Smoke grey window  
2 x

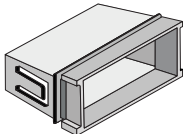

Annunciator holders  
3 x

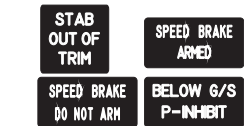

Annunciator legends

A		M6	11 x
B		M4	8 x
C		M3	11 x
D		M6 x 12	7 x
E		M6 x 12	4 x
F		M4 x 8 tapped	10 x
G		M4 x 8	16 x
H		M3 x 8	11 x

### STEP 1

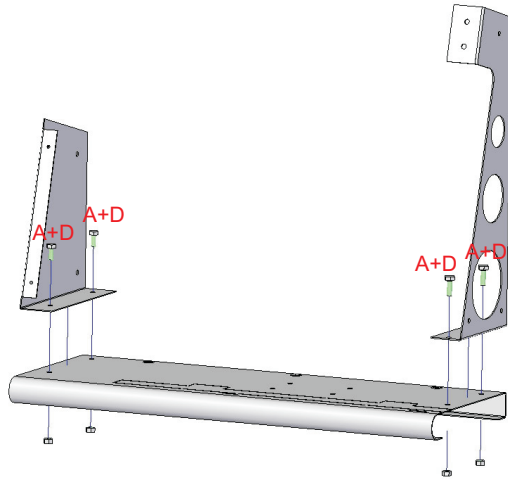

Assemble the first parts as described. use type A + D

### STEP 2

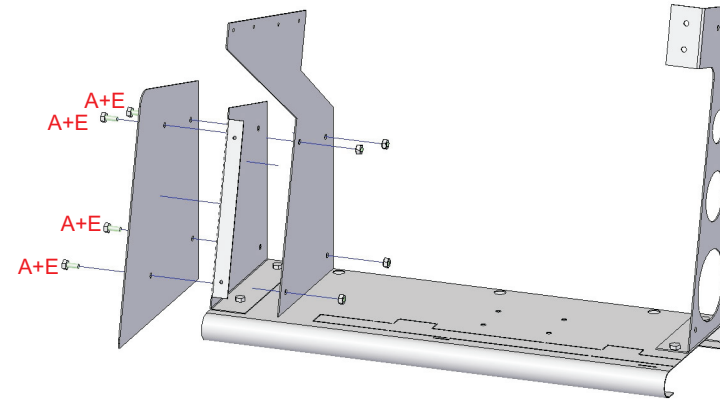

Mount the cover panel and the glare support bracket. use type A + E

### STEP 3

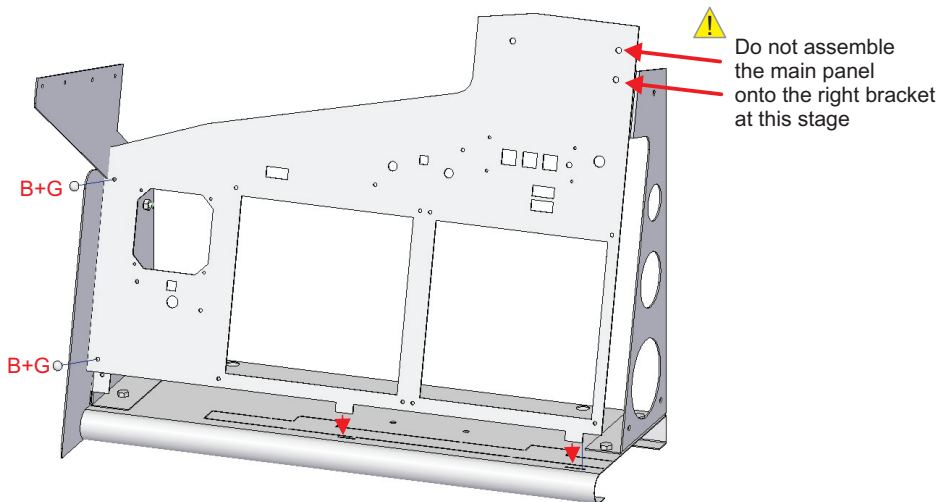

Insert the main front panel into the ground section . Use type B + G

### STEP 4

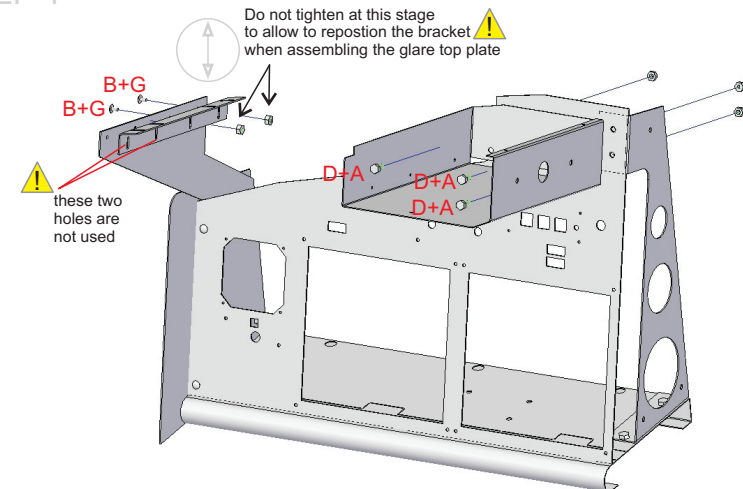

Assemble the EFIS box and the support bracket .

### STEP 5

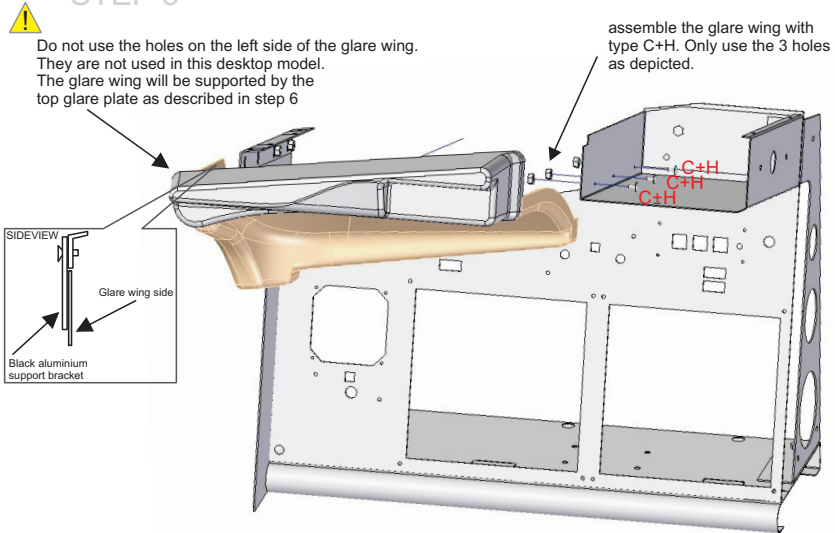

Assemble the glare wing



#### NOTE:

On the back of the bottom section notice these three holes.

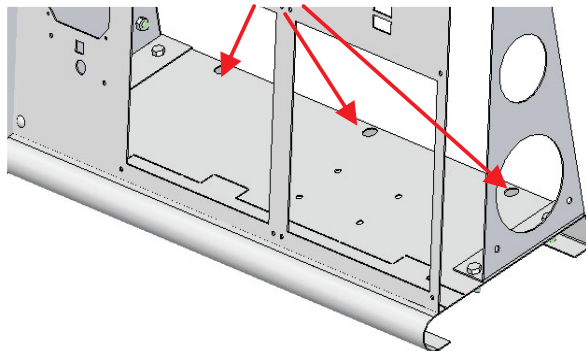

These holes are used to fixate the structure onto a desktop. It is strongly advised to do this in order to prevent the MIP from falling over.

#### NOTE:

Carefully pay attention to the assembly of the glare wing. During step 5 and 6 of the construction, make sure the glarewing is supported to prevent breaking or damage. After mounting the top glare plate, the glarewing is fully supported.

The top glare plate can be repositioned to align with the edge of the glarewing.

On the left side of the glarewing some holes are pre drilled. These holes are not used in the desktop version and should not be used for construction.

### STEP 6

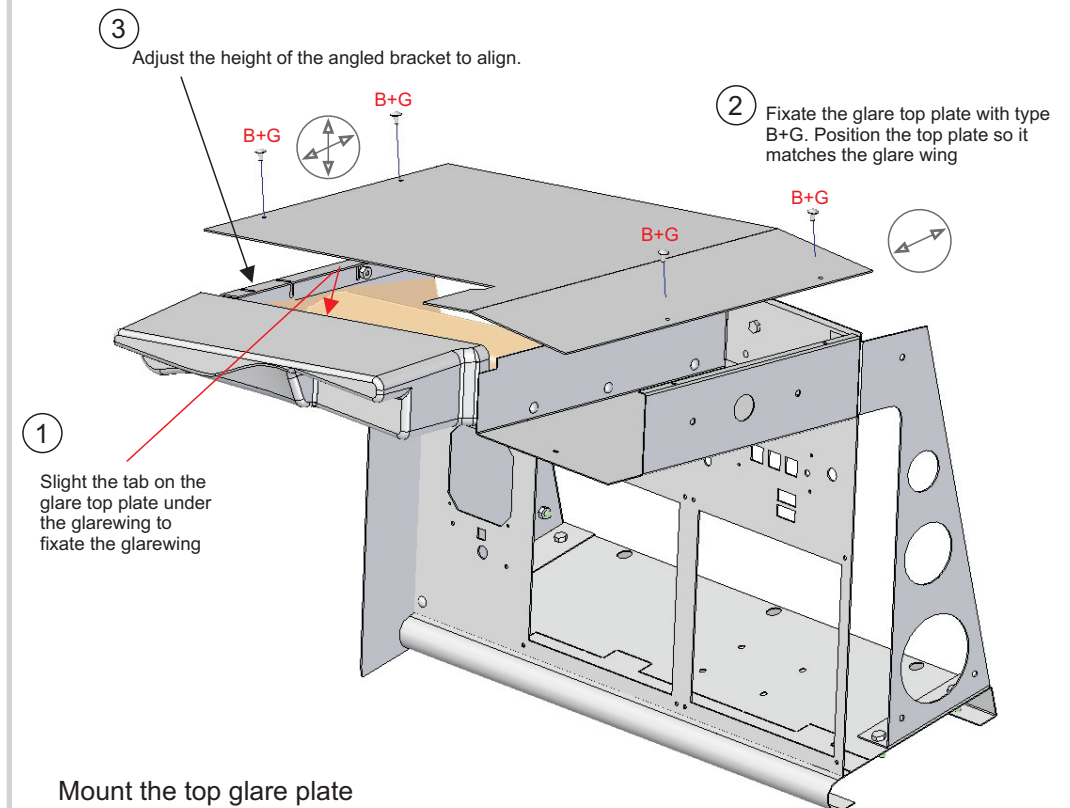

Mount the top glare plate

### STEP 7

Use type G.  
4 for each windowframe

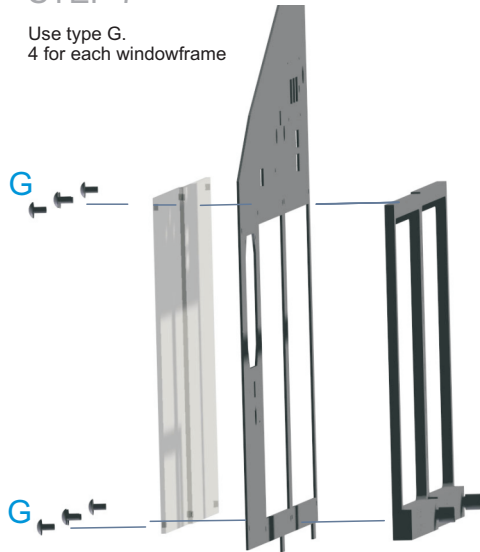

Assembly of the window frame

remove protection foil on smoke grey window

### STEP 8

Assembly of the annunciators

insert ledholder (1) into  
annunciator holder (2) first,  
then insert these parts into the main  
panel.  
Glue the legend (3) on top of holder (4) and  
insert this part into the first holder (2)

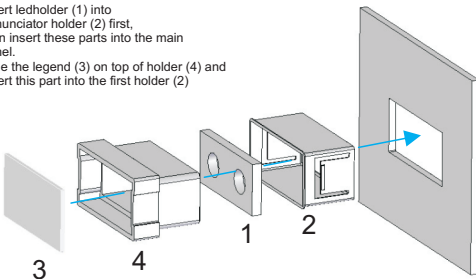

### STEP 9

Use type F selftapping parkers

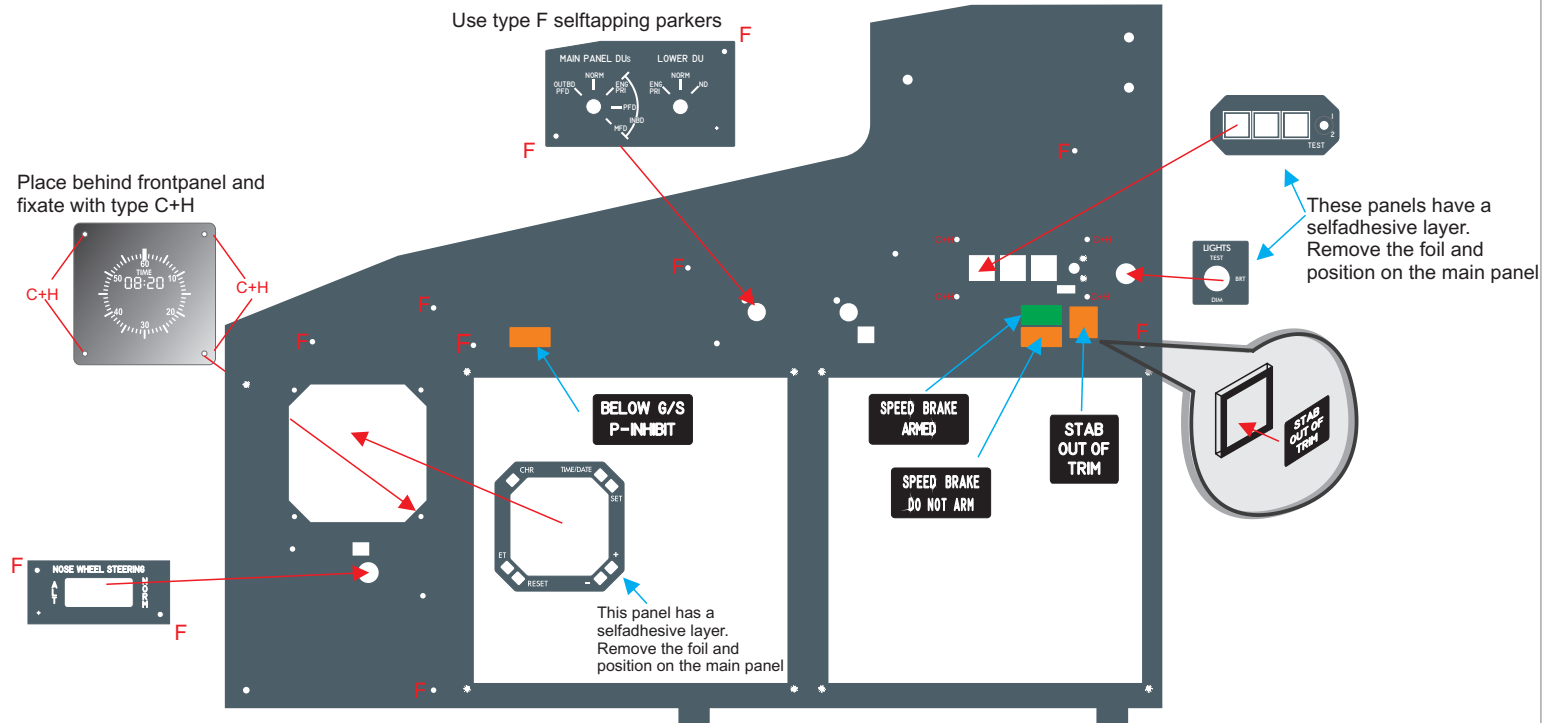

Some parkers are only used for dummy purposes. Use the types as displayed to finish your setup.



**Congratulations on finishing your desktop MIP captain panel.**

**You can upgrade your kit with the Center and First Officer section.**

**For information and available upgrade kits, please check at  
[www.flyengravity.com](http://www.flyengravity.com)**